

Installation Instructions

License Plate Bracket

Accessory

P/N 10103008P1-01 • Rev A • Sept 2013
© 2013 United Technologies Corporation.
All rights reserved.

1. Remove existing license plate and screws.
2. Use the screws from Step 1 to attach the bracket to the vehicle in such a way that frame will rotate upwards when opened.
3. Use the 1/4" screws and nuts (provided) to attach the license plate to the bracket.
4. Open and close the bracket, moving it through its entire motion to ensure no obstructions are encountered. Readjust bracket if necessary.
5. Drill two .259" (Drill Size F) holes in the vehicle corresponding with the two unused slots in the bracket. Install the two 1/4" T-Rivets (provided).
6. Mark the location of, and drill through, the bracket in the location intended to be the center of the Elante® key tube.
7. Drill a 2" hole through the bracket and into the vehicle. The hole needs to provide clearance for the key tube, approximately 3 1/2" in length.
8. Insert the tube into the bracket hole and use a pencil to mark the locations of the six rivet holes.
9. Remove the tube and drill six .162" (Drill Size #20) holes where marked.
10. Install the gasket and two spacers on the tube and re-insert the tube into the bracket-hole. Use the six 5/32" rivets to attach the tube to the bracket.
11. Install the key tube lid. Once again, move the bracket through its full range of motion to ensure proper function.

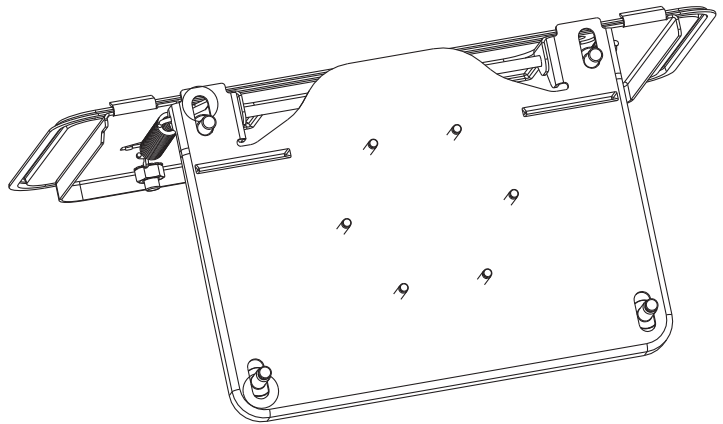
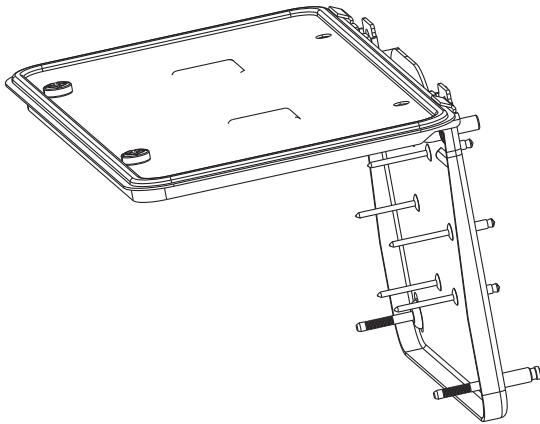

Supra
4001 Fairview Industrial Dr. SE
Salem, OR USA 97302
T 800.547.0252
F 503.375.9381
www.suprasystems.com

Technical Support
Toll-free: 866.259.8077 in the
U.S. Puerto Rico, and Canada.
Outside the toll-free area:
Contact your local dealer.