

How to *Open a TRACcess BT Smart Device* using older Apple® Products

For Supra-Hosted Customers

iPhone® 4, 3GS, & iPad® 2

Pair the Fob

1. Read and follow the manufacturer's instructions on *How to pair devices* for your specific phone or tablet.
2. Select the fob name to pair (example: SUPRA-KBS8).

1. In the TRACcess® eKEY® app, tap **Open Device**.
2. Type in the PIN Code.
3. Type in the Access Code if required.
4. Tap **Begin**.
5. For TRAC-Lock and TRAC-Lid (TRAC-Vault) devices only, press the button to turn it on. For TRAC-Box devices, skip this step.
6. Turn on the Supra eKEY Fob and point it at the TRACcess device.
7. Open the TRACcess device.

1. Tap Open Device.

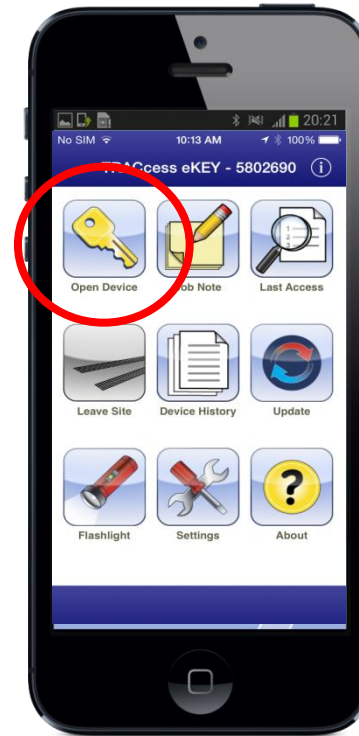

Tip: On some phones, the first time a keybox is accessed the pairing alert pops up to accept the pairing. Enter 0000 for the passcode.



How to *Open a TRACcess BT Smart Device* using older Apple® Products

2. Type in the PIN code.

iPhone 4, 3GS, and iPad 2

1. In the TRACcess® eKEY® app, tap **Open Device**.
2. Type in the PIN Code.
3. Type in the Access Code if required.
4. Tap **Begin**.
5. For TRAC-Lock and TRAC-Lid (TRAC-Vault) devices only, press the button to turn it on. For TRAC-Box devices, skip this step.
6. Turn on the Supra eKEY Fob and point it at the TRACcess device.
7. Open the TRACcess device.

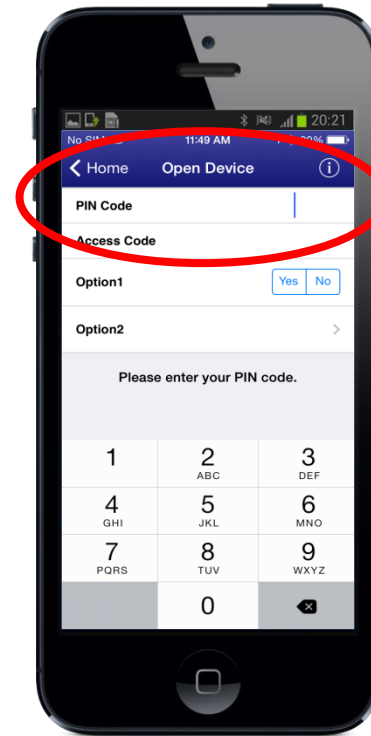

How to *Open a TRACcess BT Smart Device* using older Apple® Products

3. Type in the Access Code.

iPhone 4, 3GS, and iPad 2

1. In the TRACcess® eKEY® app, tap **Open Device**.
2. Type in the PIN Code.
3. Type in the Access Code if required.
4. Tap **Begin**.
5. For TRAC-Lock and TRAC-Lid (TRAC-Vault) devices only, press the button to turn it on. For TRAC-Box devices, skip this step.
6. Turn on the Supra eKEY Fob and point it at the TRACcess device.
7. Open the TRACcess device.

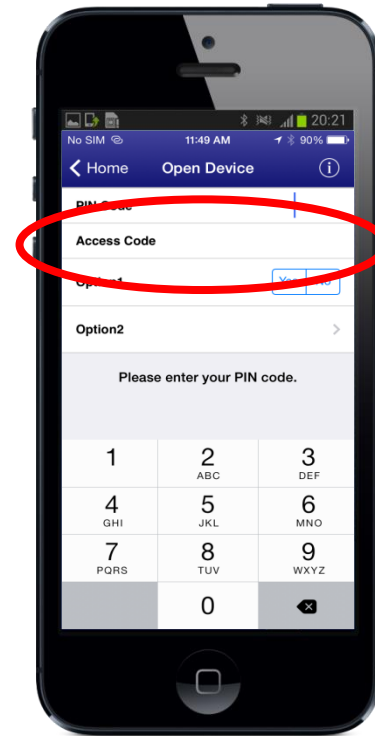

How to *Open a TRACcess BT Smart Device* using older Apple® Products

4. Tap **Begin**.

iPhone 4, 3GS, and iPad 2

1. In the TRACcess® eKEY® app, tap **Open Device**.
2. Type in the PIN Code.
3. Type in the Access Code if required.
4. Tap **Begin**.
5. For TRAC-Lock and TRAC-Lid (TRAC-Vault) devices only, press the button to turn it on. For TRAC-Box devices, skip this step.
6. Turn on the Supra eKEY Fob and point it at the TRACcess device.
7. Open the TRACcess device.

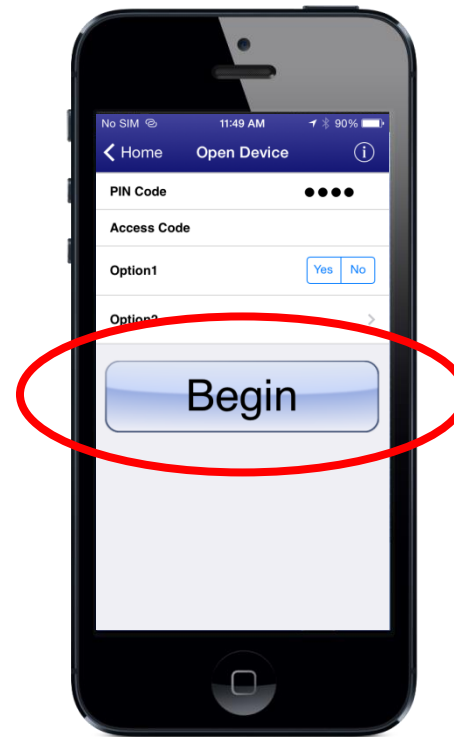

How to *Open a TRACcess BT Smart Device* using older Apple® Products

5. Turn on the TRAC-Lock or TRAC-Lid device.

iPhone 4, 3GS, and iPad 2

1. In the TRACcess® eKEY® app, tap **Open Device**.
2. Type in the PIN Code.
3. Type in the Access Code if required.
4. Tap **Begin**.
5. For TRAC-Lock and TRAC-Lid (TRAC-Vault) devices only, press the button to turn it on. For TRAC-Box devices, skip this step.
6. Turn on the Supra eKEY Fob and point it at the TRACcess device.
7. Open the TRACcess device.



How to *Open a TRACcess BT Smart Device* using older Apple® Products

6. Turn on the fob and point it at the TRACcess device.

iPhone 4, 3GS, and iPad 2

1. In the TRACcess® eKEY® app, tap **Open Device**.
2. Type in the PIN Code.
3. Type in the Access Code if required.
4. Tap **Begin**.
5. For TRAC-Lock and TRAC-Lid (TRAC-Vault) devices only, press the button to turn it on. For TRAC-Box devices, skip this step.
6. Turn on the Supra eKEY Fob and point it at the TRACcess device.
7. Open the TRACcess device.



How to *Open a TRACcess BT Smart Device* using older Apple® Products

7. Open the TRACcess device.

iPhone 4, 3GS, and iPad 2

1. In the TRACcess® eKEY® app, tap **Open Device**.
2. Type in the PIN Code.
3. Type in the Access Code if required.
4. Tap **Begin**.
5. For TRAC-Lock and TRAC-Lid (TRAC-Vault) devices only, press the button to turn it on. For TRAC-Box devices, skip this step.
6. Turn on the Supra eKEY Fob and point it at the TRACcess device.
7. Open the TRACcess device.



For the latest information, visit us at
www.tracessmanager.com.

Select **Downloads and Resources** for instructional videos,
How-To's, and more.

